

GAIN AND OFFSET ADJUSTMENTS SEALED (CODE 'Y')

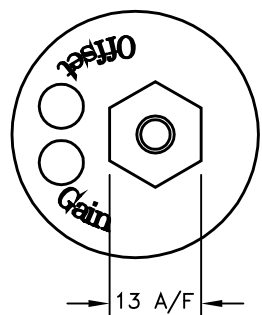

IP67 SHORT CABLE GLAND (CODE 'Mxx')

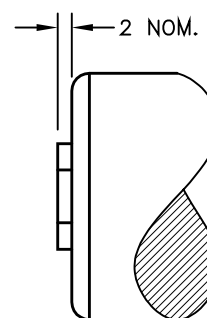

NOTE: SENSORS WITH TRAVEL UPTO 50mm ARE MADE TO STANDARD LENGTHS.

TRAVEL (mm)	BODY LENGTH: (mm)	
	'X' STANDARD	'Y' FLANGE
2 - 10	65.0	81.3
11 - 20	75.0	91.3
21 - 30	85.0	101.3
31 - 50	105.0	121.3
51 - 100	55 + TRAVEL	71.3 + TRAVEL

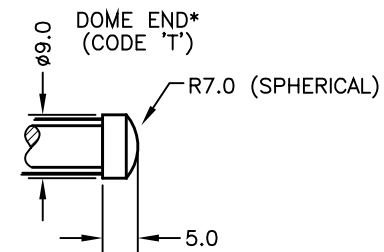

ELECTRICAL OPTIONS/ SPECIFICATIONS

OUTPUT OPTION	OUTPUT		SUPPLY	
	A	0.5 TO 4.5V RATIOMETRIC	5V	STANDARD
B	±5V	±15V		
C	0.5 TO 9.5V	24V		
D	±10V	±15V		
E	0.5 TO 4.5V	24V		
F	SUPPLY CURRENT 12mA TYP. 20mA MAX.			BUFFERED
G	4 TO 20mA 2-WIRE	24V		
H	4 TO 20mA 3-WIRE SINK	24V		
	4 TO 20mA 3-WIRE SOURCE	24V		

SINK VERSION OUTPUT COMPLIANCE 5-28V  
SOURCE VERSION DRIVE 300Ω MAX TO 0V

CABLE LENGTH, OPTIONS 'Lxx' OR 'Mxx', ORDERED IN cm, 50cm STANDARD OR AS REQUIRED.

3-CORE SCREENED: 0.2mm<sup>2</sup>, Ø4mm PUR JACKET  
4-CORE SCREENED: 0.2mm<sup>2</sup>, Ø4.6mm PUR JACKET

CABLE/CONNECTOR CONNECTIONS\*:  
3 CORE 4 CORE CONNECTOR

RED	RED	:1	+Ve
BLACK	GREEN	:3	0V
YELLOW	YELLOW	:4	-Ve - OPTIONS: B OR D
WHITE	BLUE	:2	OUTPUT
SCREEN	SCREEN	:4	BODY - OPTIONS: A, C, E-H

\*CONNECTORS; MAXIMUM CONDUCTOR CROSS SECTION 0.75mm<sup>2</sup>  
RANGE OF DISPLACEMENT FROM 2mm TO 100mm, IN INCREMENTS OF 1mm.

BODY MATERIAL: STAINLESS STEEL.

FLANGE MATERIAL: ALUMINIUM (CODE 'N')

FURTHER OPTIONS:

SINGLE PAIR OF BODY CLAMPS 'P'

SPRUNG PUSH-ROD, TO EXTENDED POSITION (CODE R)

DOME END (CODE T) IN CONJUNCTION WITH SPRUNG

PUSH-ROD (CODE R)\*

PUSH-ROD FREE (CODE 'V')

N.b. NOT AVAILABLE WITH SPRUNG OPTIONS.

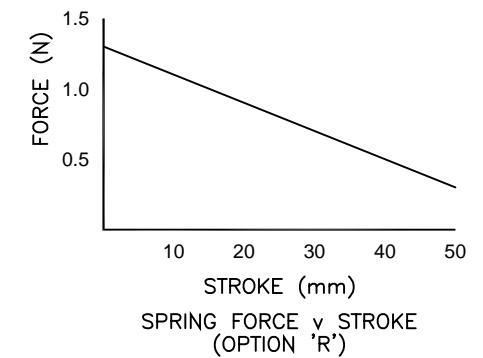

F	M4x0.7 WAS M2.5x0.5, BEARING BOBBIN END MODIFIED (RAN 136)	PDM
G	BULL NOSE COND'N NOTE MODIFIED	PDM
H	OPTIONS MODIFIED	PDM
I	START OF TRAVEL ADDED OPTION N	RDS
J	FLANGE TH'KNNESS ADDED.	PDM
K	ADDITIONAL DIMS/VIEWS ADDED.	PDM

DRAWINGS NOT TO BE CHANGED WITHOUT REFERENCE TO THE CHANGE PROCEDURE.  
CHANGES TO PARTS USED IN INTRINSICALLY SAFE PRODUCT MUST BE APPROVED BY THE AUTHORISED PERSON  
THIS IS AN UNCONTROLLED PRINT AND WILL NOT BE UPDATED.



F	10/04/06		CHECKED BY	X	±0.4
G	23/05/06		RDS	X.X	±0.2
H	16/10/06			X.XX	±0.1
					DIMS mm
I	7/10/09	DESCRIPTION			
J	05/01/10	P103 LIPS SHORT STROKE			
K	05/07/11	LINEAR POSITION SENSOR			
		SCALE	DRAWING NUMBER	P103-11	REV [K]
		10mm			SHEET [1] OF [1]