

**ELECTRICAL OPTIONS/ SPECIFICATIONS**

| OUTPUT OPTION                      | OUTPUT                  |                         | SUPPLY     |          |
|------------------------------------|-------------------------|-------------------------|------------|----------|
|                                    | A                       | 0.5 TO 4.5V RATIOMETRIC | 5V         | STANDARD |
| B                                  | ±5V                     | ±15V                    | } BUFFERED |          |
| C                                  | 0.5 TO 9.5V             | 24V                     |            |          |
| D                                  | ±10V                    | ±15V                    |            |          |
| G                                  | 0.5 TO 4.5V             | 24V                     |            |          |
| SUPPLY CURRENT 12mA TYP. 20mA MAX. |                         |                         |            |          |
| E                                  | 4 TO 20mA 2-WIRE        | 24V                     |            |          |
| F                                  | 4 TO 20mA 3-WIRE SINK   | 24V                     |            |          |
| H                                  | 4 TO 20mA 3-WIRE SOURCE | 24V                     |            |          |

SINK VERSION OUTPUT COMPLIANCE 5-28V  
SOURCE VERSION DRIVE 300Ω MAX TO 0V

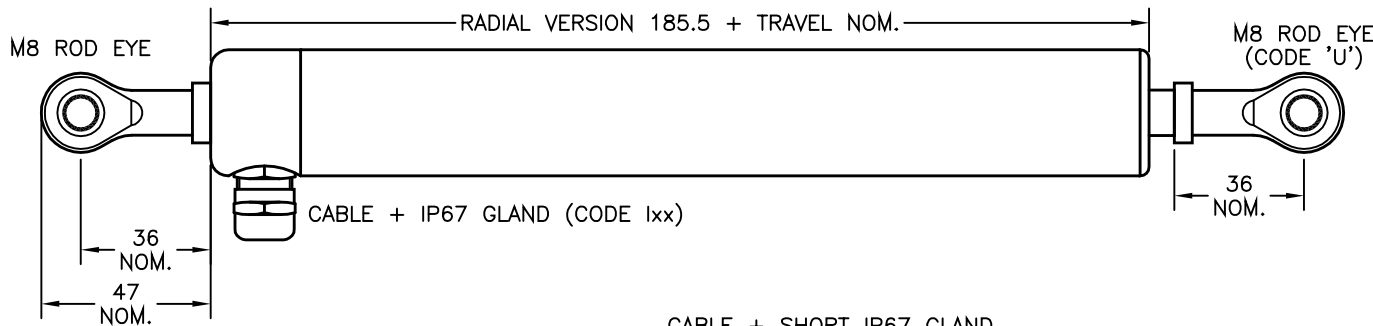

CABLE LENGTH ORDERED IN cm.  
3-CORE SCREENED: 0.2mm<sup>2</sup>, Ø4mm PUR JACKET  
4-CORE SCREENED: 0.2mm<sup>2</sup>, Ø4.6mm PUR JACKET

CABLE/CONNECTOR CONNECTIONS;

| 3 CORE | 4 CORE | CONNECTOR |                           |
|--------|--------|-----------|---------------------------|
| RED    | RED    | 1         | +Ve                       |
| BLACK  | GREEN  | 3         | 0V                        |
|        | YELLOW | 4         | -Ve (OPTIONS: B OR D)     |
| WHITE  | BLUE   | 2         | OUTPUT                    |
| SCREEN | SCREEN | 4         | BODY (OPTIONS: A, C, E-H) |

BODY MATERIAL:- STAINLESS STEEL.

- FURTHER OPTIONS:  
 BODY CLAMP/S CODE 'P'/'P2'  
 SPRING RETURN PUSH-ROD, TRAVEL <250mm  
 RETURN TO EXTENDED POSITION (CODE R)  
 RETURN TO RETRACTED POSITION (CODE S)  
 PUSH-ROD FREE (CODE 'V')

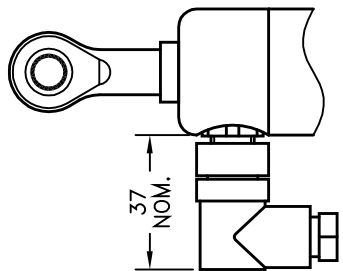

IP67 M12 CONNECTOR - RADIAL (CODE 'K')

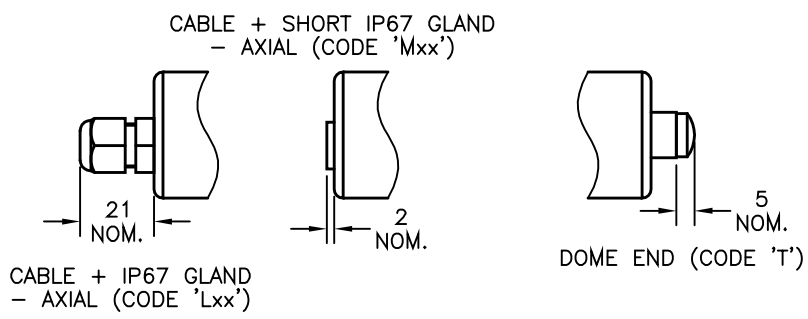

|   |   |     |
|---|---|-----|
| F | BODY ROD-EYE ON RADIAL VERSIONS NOT AN OPTION | PDM |
| G | OPTION 'T' ADDED.                             | PDM |
|   |   |     |
|   |   |     |

THE PUSH-ROD RETRACTS A FURTHER 4mm NOM. FROM START OF CALIBRATED TRAVEL. PUSH-ROD EXTENDS A FURTHER 8mm NOM. FROM END OF CALIBRATED TRAVEL FOR STANDARD VERSIONS, OR 3mm FOR SPRUNG 'R' AND 'S' CODED SENSORS. 'V' CODED PUSH-ROD WILL DEPART SENSOR BODY.

DRAWINGS NOT TO BE CHANGED WITHOUT REFERENCE TO THE CHANGE PROCEDURE. CHANGES TO PARTS USED IN INTRINSICALLY SAFE PRODUCT MUST BE APPROVED BY THE AUTHORISED PERSON  
THIS IS AN UNCONTROLLED PRINT AND WILL NOT BE UPDATED.



|   |          |                              |           |
|---|----------|------------------------------|-----------|
| F   | 28/06/07 | CHECKED BY<br>RDS            | X ±0.4    |
| G   | 07/05/08 |                              | X.X ±0.2  |
|   |          |                              | X.XX ±0.1 |
|   |          |                              | DIMS mm   |
| DESCRIPTION   |          |                              |           |
| P111 LIPS RUGGED STAND ALONE LINEAR POSITION SENSOR |          |                              |           |
| SCALE<br>20mm                                       |          | DRAWING NUMBER P111-11 REV G |           |
|   |          | SHEET 1 OF 1                 |           |