

IP67 M12 CONNECTOR
- RADIAL (CODE 'K')

CABLE + SHORT IP67 GLAND
- AXIAL (CODE 'Mxx')

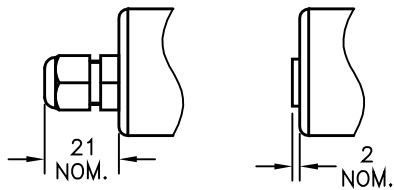

CABLE + IP67 GLAND
- AXIAL (CODE 'Lxx')

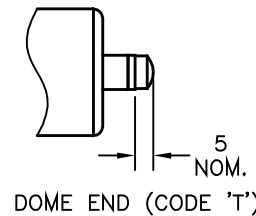

DOMES END (CODE 'T')

ELECTRICAL SPECIFICATIONS

OUTPUT	SUPPLY
0.5 TO 4.5V RATIO METRIC	5V

CABLE LENGTH ORDERED IN cm. 1500cm MAX.
3-CORE SCREENED: 0.2mm², Ø4mm PUR JACKET

CABLE/CONNECTOR CONNECTIONS;

3 CORE CONNECTOR		
RED	1	+Ve
BLACK	3	0V
WHITE	2	OUTPUT
SCREEN	4	BODY

BODY MATERIAL:- STAINLESS STEEL.

FURTHER OPTIONS:

BODY CLAMP/S CODE 'P'/'P2')

SPRING RETURN PUSH-ROD, TRAVEL <250mm

RETURN TO EXTENDED POSITION (CODE R)

RETURN TO RETRACTED POSITION (CODE S)

PUSH-ROD FREE (CODE 'V')

NOTE:- READ INSTALLATION SHEET X101-19
FOR FULL INSTRUCTIONS FOR USE.

ATEX APPROVED TO
II 1G
Ex ia IIC T4 (Ta= -40° to +80°C)
Ui 11.4V, Ii 0.46A, Pi 0.51W
APPROVED FOR USE WITH A GALVANICALLY ISOLATED BARRIER.

C	RADIAL VERSION LENGTH CORRECTED, OPTIONS ADDED.	PDM
D	S OPTION ADDED.	RDS
E	NOMENCLATURE MODIFIED.	PDM
F	PUSH-ROD NOTES AMENDED~RAN165, M5 STUD SHOWN ON RADIAL BODY.	PDM
G	STUD REMOVED FROM RADIAL BODY.	PDM

THE PUSH-ROD RETRACTS A FURTHER 4mm NOM. FROM START OF CALIBRATED TRAVEL. PUSH-ROD EXTENDS A FURTHER 8mm NOM. FROM END OF CALIBRATED TRAVEL FOR STANDARD VERSIONS, OR 3mm FOR SPRUNG 'R' AND 'S' CODED SENSORS. 'V' CODED PUSH-ROD WILL DEPART SENSOR BODY.

DRAWINGS NOT TO BE CHANGED WITHOUT REFERENCE TO THE CHANGE PROCEDURE. CHANGES TO PARTS USED IN INTRINSICALLY SAFE PRODUCT MUST BE APPROVED BY THE AUTHORISED PERSON
THIS IS AN UNCONTROLLED PRINT AND WILL NOT BE UPDATED.

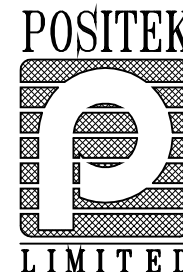

C	22/11/05		CHECKED BY	X	±0.4
D	10/5/06		RDS	X.X	±0.2
E	16/10/06			X.XX	±0.1
F	09/03/07	DESCRIPTION			
G	28/06/07	X101 INTRINSICALLY SAFE STAND ALONE LINEAR POSITION SENSOR			
SCALE 20mm 		DRAWING NUMBER X101-11		REV	G
SHEET 1 OF 1					