

CABLE + SHORT IP67 GLAND - AXIAL (CODE 'Mxx')

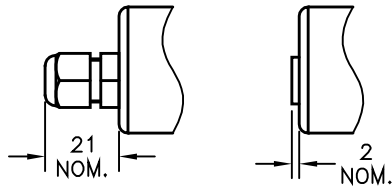

CABLE + IP67 GLAND - AXIAL (CODE 'Lxx')

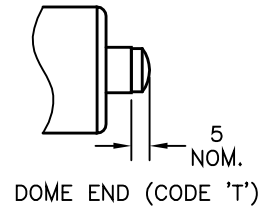

IP67 M12 CONNECTOR - RADIAL (CODE 'K')

| | | |
|---|---|-----|
| G | BODY ROD-EYE ON RADIAL VERSIONS NOT AN OPTION | PDM |
| H | OPTION 'T' ADDED. | PDM |
| | | |
| | | |
| | | |

THE PUSH-ROD RETRACTS A FURTHER 4mm NOM. FROM START OF CALIBRATED TRAVEL. PUSH-ROD EXTENDS A FURTHER 8mm NOM. FROM END OF CALIBRATED TRAVEL FOR STANDARD VERSIONS, OR 3mm FOR SPRUNG 'R' AND 'S' CODED SENSORS. 'V' CODED PUSH-ROD WILL DEPART SENSOR BODY.

DRAWINGS NOT TO BE CHANGED WITHOUT REFERENCE TO THE CHANGE PROCEDURE. CHANGES TO PARTS USED IN INTRINSICALLY SAFE PRODUCT MUST BE APPROVED BY THE AUTHORISED PERSON
THIS IS AN UNCONTROLLED PRINT AND WILL NOT BE UPDATED.

ELECTRICAL SPECIFICATIONS

| | |
|--------------------------|---------------|
| OUTPUT | SUPPLY |
| 0.5 TO 4.5V RATIO METRIC | 5V |

CABLE LENGTH ORDERED IN cm. 1500cm MAX.
3-CORE SCREENED: 0.2mm², ø4mm PUR JACKET

CABLE/CONNECTOR CONNECTIONS;

| | |
|------------------|----------|
| 3 CORE CONNECTOR | |
| RED | 1 +Ve |
| BLACK | 3 0V |
| WHITE | 2 OUTPUT |
| SCREEN | 4 BODY |

BODY MATERIAL:- STAINLESS STEEL.

FURTHER OPTIONS:

- BODY CLAMP/S CODE 'P'/'P2')
- SPRING RETURN PUSH-ROD, TRAVEL <250mm
- RETURN TO EXTENDED POSITION (CODE R)
- RETURN TO RETRACTED POSITION (CODE S)
- PUSH-ROD FREE (CODE 'V')

NOTE:- READ INSTALLATION SHEET X111-19 FOR FULL INSTRUCTIONS FOR USE.

| |
|--|
| ATEX APPROVED TO |
| II 1G |
| Ex ia IIC T4 (Ta= -40° to +80°C) |
| Ui 11.4V, li 0.46A, Pi 0.51W |
| APPROVED FOR USE WITH A GALVANICALLY ISOLATED BARRIER. |

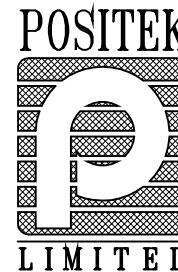

| | | | | |
|--------------|----------|----------------|---|-----------|
| G | 28/06/07 | | CHECKED BY | X ±0.4 |
| H | 28/06/07 | | RDS | X.X ±0.2 |
| | | | | X.XX ±0.1 |
| | | | | DIMS mm |
| DESCRIPTION | | | X111 INTRINSICALLY SAFE RUGGED STAND ALONE LINEAR POSITION SENSOR | |
| SCALE | 20mm | DRAWING NUMBER | X111-11 | REV H |
| SHEET 1 OF 1 | | | | |