

NOTE: SENSORS WITH TRAVEL UPTO 50mm ARE MADE TO STANDARD LENGTHS.

TRAVEL (mm)	BODY LENGTH: (mm)	
	'X' STANDARD	'Y' FLANGE
2 - 10	65.0	81.3
11 - 20	75.0	91.3
21 - 30	85.0	101.3
31 - 50	105.0	121.3
51 - 100	55 + TRAVEL	71.3 + TRAVEL

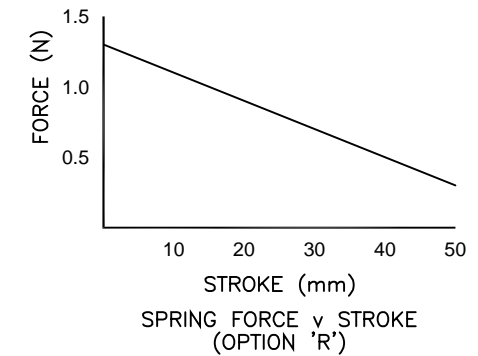
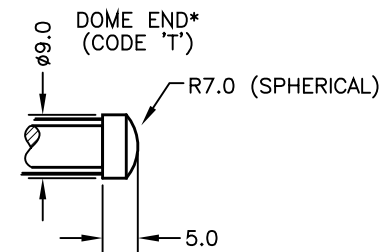

ELECTRICAL OPTIONS/ SPECIFICATIONS
OUTPUT SUPPLY
 0.5 TO 4.5V RATIO METRIC 5V
 SUPPLY CURRENT 12mA TYP. 20mA MAX.

CABLE LENGTH, OPTIONS 'Lxx' OR 'Mxx', ORDERED IN cm, 50cm STANDARD OR AS REQUIRED, 15000cm MAX.
 3-CORE SCREENED: 0.2mm², 4mm PUR JACKET
 CABLE/CONNECTOR CONNECTIONS*;
 3 CORE CONNECTOR

RED :1 +Ve
 BLACK :3 0V
 WHITE :2 OUTPUT
 SCREEN :4 BODY

*CONNECTORS; MAXIMUM CONDUCTOR CROSS SECTION 0.75mm²
 RANGE OF DISPLACEMENT FROM 2mm TO 100mm, IN INCREMENTS OF 1mm.

BODY MATERIAL: STAINLESS STEEL.
 FLANGE MATERIAL: STAINLESS STEEL (CODE 'N')

FURTHER OPTIONS:
 SINGLE PAIR OF BODY CLAMPS 'P'
 SPRUNG PUSH-ROD, TO EXTENDED POSITION (CODE R)
 DOME END (CODE T) IN CONJUNCTION WITH SPRUNG PUSH-ROD (CODE R)*
 PUSH-ROD FREE (CODE 'V')
 N.b. NOT AVAILABLE WITH SPRUNG OPTIONS.

NOTE:- READ INSTALLATION SHEET X103-19 FOR FULL INSTRUCTIONS FOR USE.

ATEX APPROVED TO
 II 1G
 EEx ia IIC T4 (Ta = -40° to +80°C)
 Ui 11.4V, Ii 0.2A, Pi 0.51W

APPROVED FOR USE IN CONJUNCTION WITH A GALVANICALLY ISOLATED BARRIER.

GAIN AND OFFSET ADJUSTMENTS SEALED (CODE 'Y')

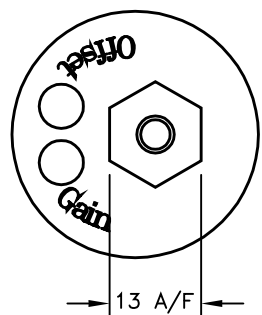

I	ADDITIONAL DIMS/VIEWS ADDED.	PDM

DRAWINGS NOT TO BE CHANGED WITHOUT REFERENCE TO THE CHANGE PROCEDURE.
 CHANGES TO PARTS USED IN INTRINSICALLY SAFE PRODUCT MUST BE APPROVED BY THE AUTHORISED PERSON
 THIS IS AN UNCONTROLLED PRINT AND WILL NOT BE UPDATED.



I	05/07/11		CHECKED BY	X	±0.4
			RDS	X.X	±0.2
				X.XX	±0.1
				DIMS	mm
DESCRIPTION					
X103 INTRINSICALLY SAFE SHORT STROKE LINEAR POSITION SENSOR					
SCALE		DRAWING NUMBER X103-11 REV 1			
10mm					
		SHEET 1 OF 1			